



# **PROMENADES KING**

## **2207-2219, KING STREET WEST**

**OFFICE AND COMMERCIAL – 1 600 to 10 000 SQ.FT.**





# INFORMATION

## PROMENADES KING – 2207-2219, KING STREET WEST

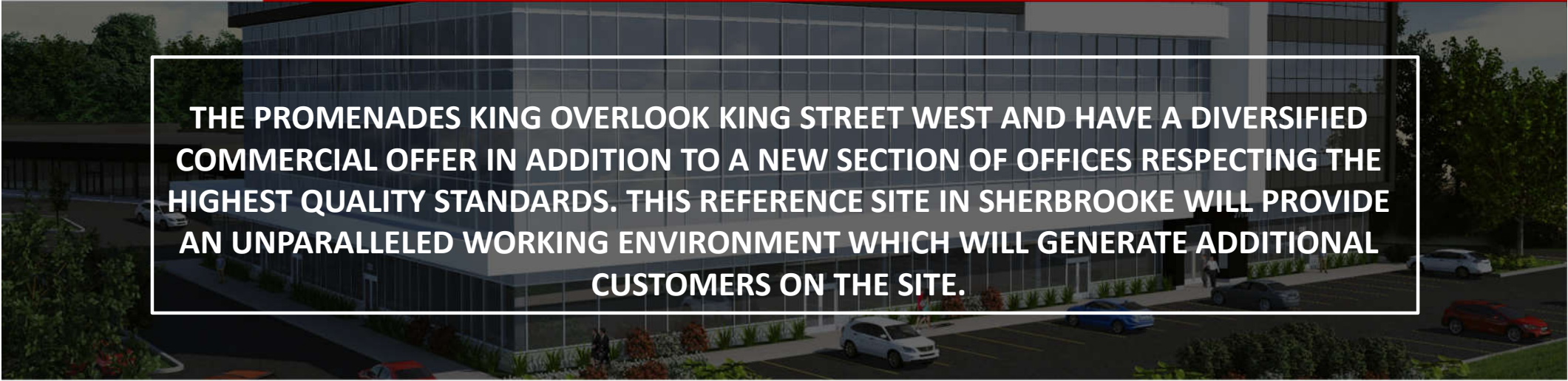

**THE PROMENADES KING OVERLOOK KING STREET WEST AND HAVE A DIVERSIFIED COMMERCIAL OFFER IN ADDITION TO A NEW SECTION OF OFFICES RESPECTING THE HIGHEST QUALITY STANDARDS. THIS REFERENCE SITE IN SHERBROOKE WILL PROVIDE AN UNPARALLELED WORKING ENVIRONMENT WHICH WILL GENERATE ADDITIONAL CUSTOMERS ON THE SITE.**

### LOCATION

- Promenades King shopping center is located on the north side of King Street West between Lomas and Farwell Streets.

#### **Easy access to the shopping center:**

- 5 accesses on 2 streets (King West and Lomas Streets) with traffic lights facilitating direct access to the site from both the East and the West.

### DETAILS

- +/- 100,000 sq. ft. of office and commercial spaces on 4 floors.
- Elevators and green terrace on the roof overlooking the Magog River and the Bellevue and Orford mountains for employees.
- Access to a private training room on the ground floor of the building (free weights, cardio machines and room for private group lessons available on reservation) for office tenants. Changing rooms and showers on site.
- More than 900 outdoor parking spaces for clients and employees and approximately 75 indoor spaces for employees.
- Energy savings with geothermal heating and cooling system.



# CURRENT TENANTS

## PROMENADES KING

2207-2219, King Street West



**CARON**  
CHAUSSURES



**BISTRO LE LOUIS XVI**



# PHOTOS

## PROMENADES KING / 2207-2219 KING STREET WEST





# PHOTOS

## PROMENADES KING / 2207-2219 KING STREET WEST





# MAP

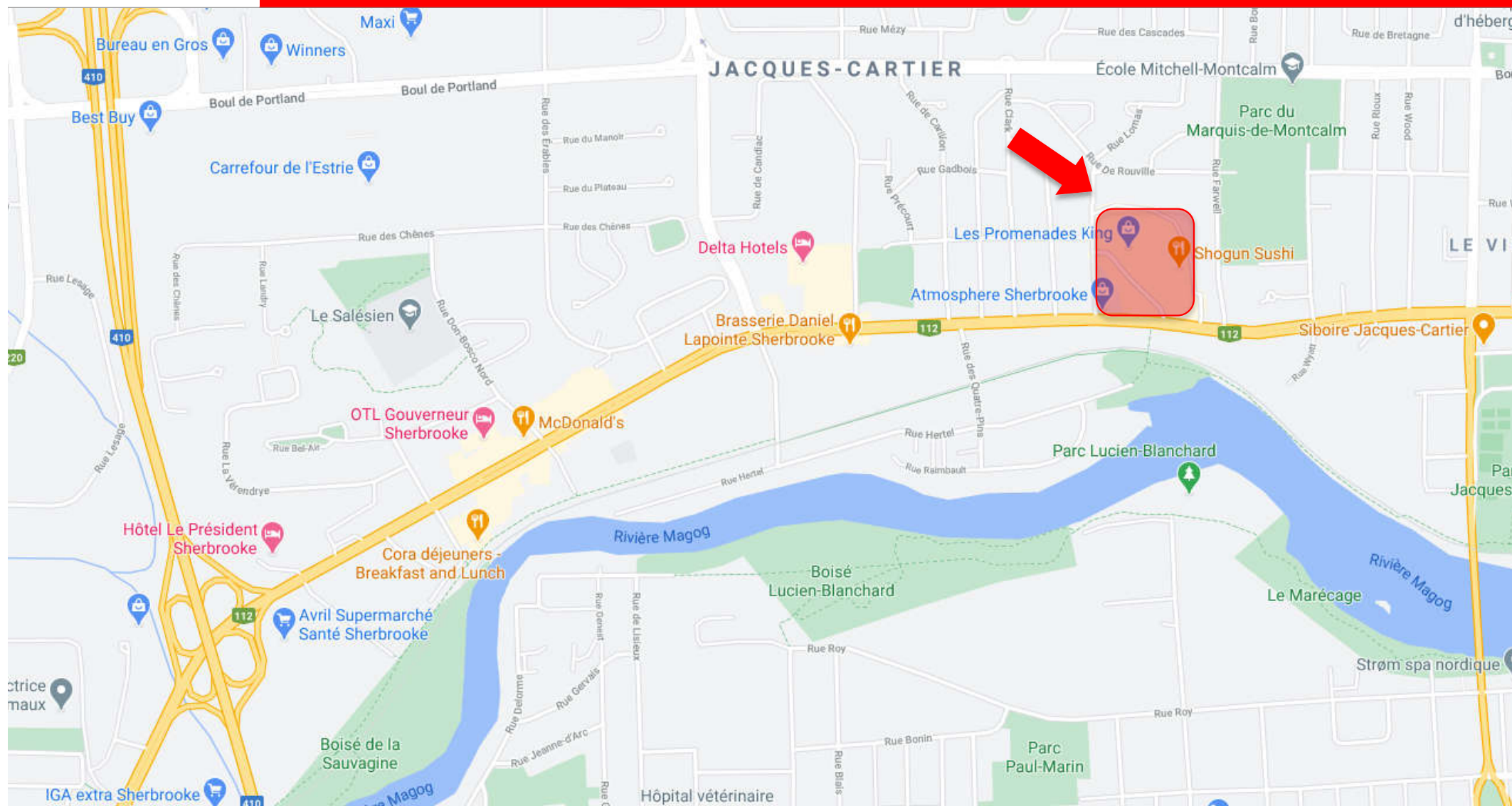

PROMENADES KING – 2207-2219, KING STREET WEST

CONTACT : GENEVIÈVE THERRIEN/ 819-348-2222  
GTHERRIEN@IMMEX.CA / IMMEX.CA



# SITE PLAN PROMENADES KING

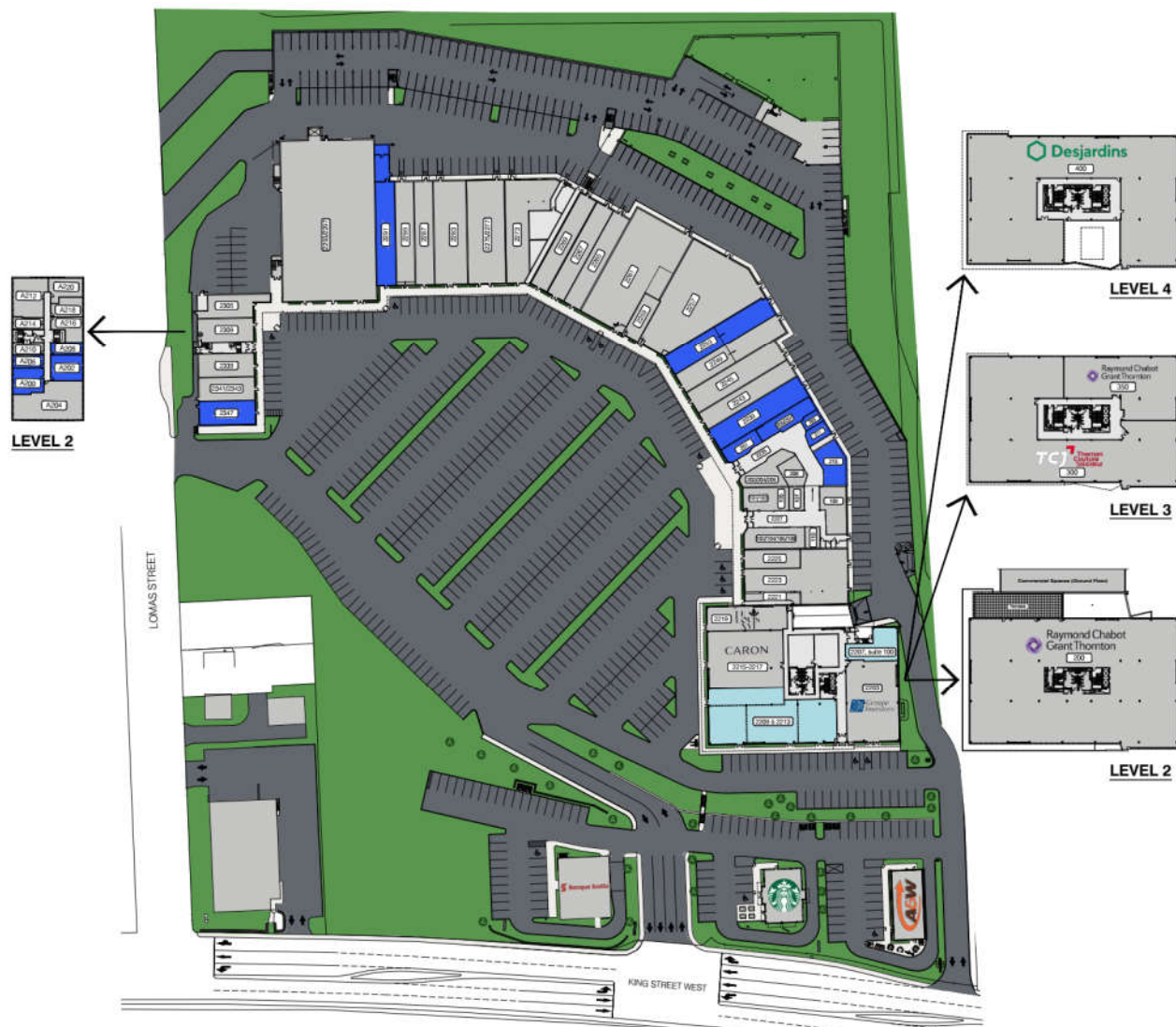

## LIST OF SPACES - COMMERCIAL PREMISES

2221 LE LOUIS XV	2227
2223 SHOOLIN SUSHI RESTAURANT	2227 MAIL
2225 BOUTIQUE SKINNER & NADEAU	2227
2226 SPACE FOR LEASE	2227
2243 BOUTIQUE SUBTILE	2227
2245 BOUTIQUE ORIENT	2227
2248 GOURMANDE BOUTIQUE	2227
2253 SPACE FOR LEASE	2227
2257 LASER GAME EVOLUTION	2227
2259 LES BARBIERS KING	2227
2261 PHARMACIE FAMILIARIS	2227
2265 CHOCO-LA	2227
2267 BOUTIQUE FAN CLUB	2227
2269 BOUTIQUE FILLES D'ÈVE	2227
2273 ORANGE THEORY	2227
2275 OPTO PLUS	2227
2283 GREYER	2227
2287 MODE JULES VERREAULT	2227
2289 BOUTIQUE POUR LUI	2227
2291 SPACE FOR LEASE	2227
2293 RENAISSANCE FRÈRE-PRIX	2227
2221	2227
2223	2227
2225	2227
2226	2227
2243	2227
2245	2227
2248	2227
2253	2227
2257	2227
2259	2227
2261	2227
2265	2227
2267	2227
2269	2227
2273	2227
2275	2227
2283	2227
2287	2227
2289	2227
2291	2227
2293	2227
2221	2227
2223	2227
2225	2227
2226	2227
2243	2227
2245	2227
2248	2227
2253	2227
2257	2227
2259	2227
2261	2227
2265	2227
2267	2227
2269	2227
2273	2227
2275	2227
2283	2227
2287	2227
2289	2227
2291	2227
2293	2227

## LIST OF SPACES - OFFICE BUILDING

2200 INVESTORS
2207 SPACE FOR LEASE
2207 RENTABLE AREA: 1 036 SQ. FT.
2209 TO 2213 SPACE FOR LEASE (SUBDIVISIBLE)
2209 TO 2213 RENTABLE AREA: 6 913 SQ. FT. MAX.
2215 CARON CHAUSSEURES
2219 LE LOUIS XV RESTAURANT
2200 RAYMOND CHABOT
2200 GRANT THORNTON
2200 THERIEN COUTURE JOUJOUR
2200 RAYMOND CHABOT
2200 GRANT THORNTON
2200 DESJARDINS

## LEGEND

■	SPACES FOR LEASE
■	RENTED SPACES

LES PROMENADES KING



# PLAN 2207, KING STREET WEST

## GROUND FLOOR / PROMENADES KING

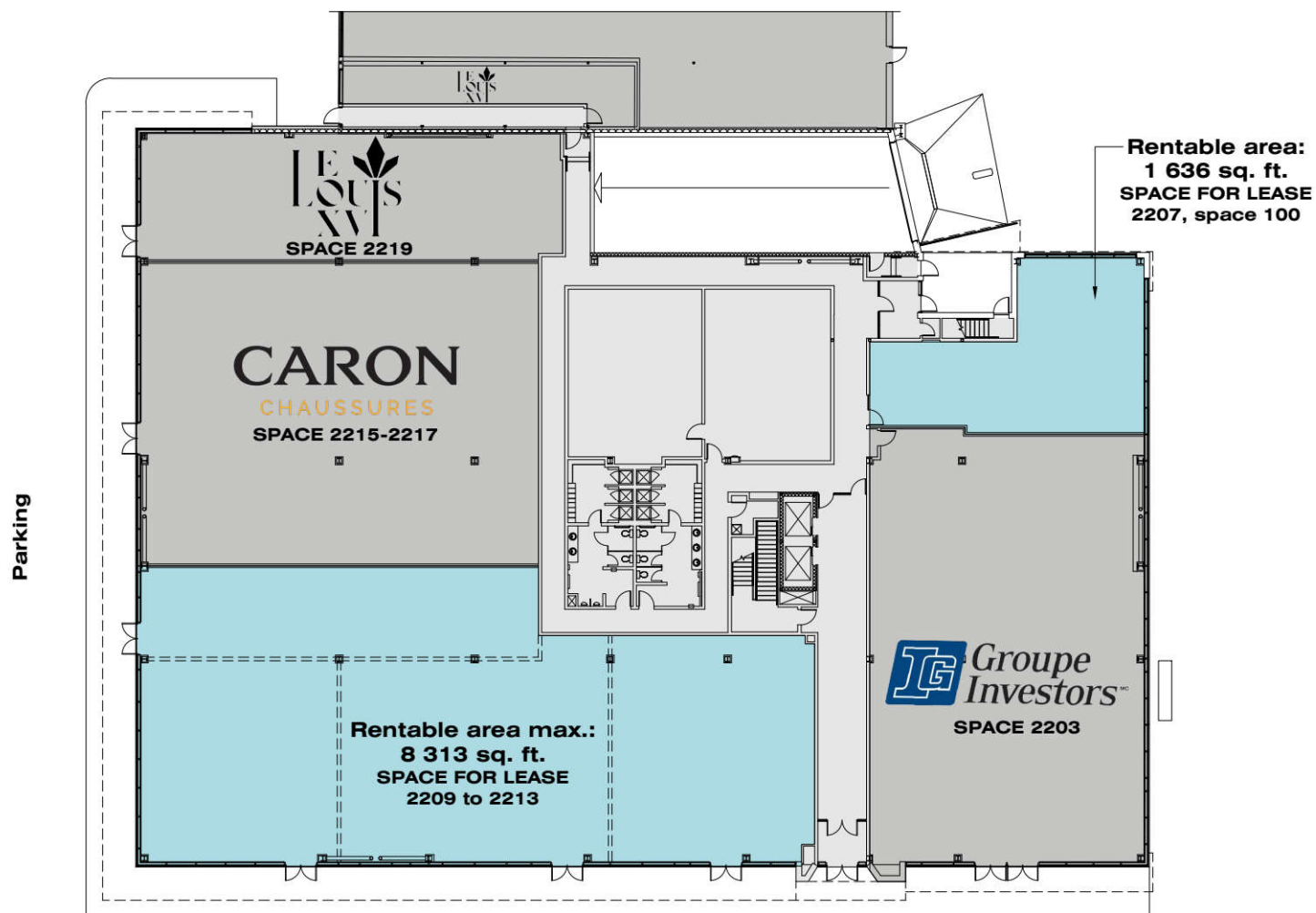

\* Dividing walls can be added as required.

GROUND FLOOR

King Street West



# PLAN 2207, KING STREET WEST

## LEVEL 2 / PROMENADES KING

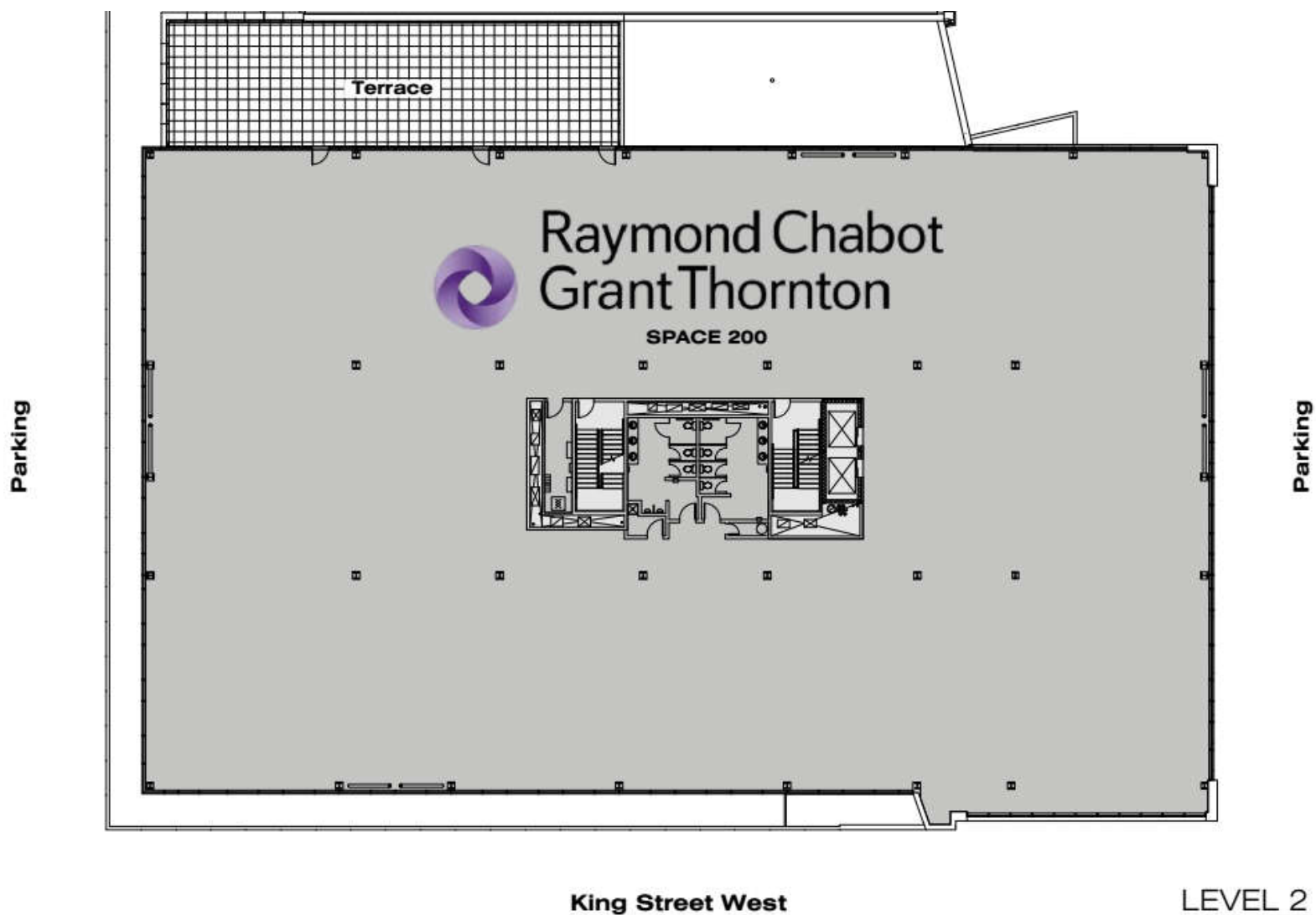



# PLAN 2207, KING STREET WEST

## LEVEL 3 / PROMENADES KING

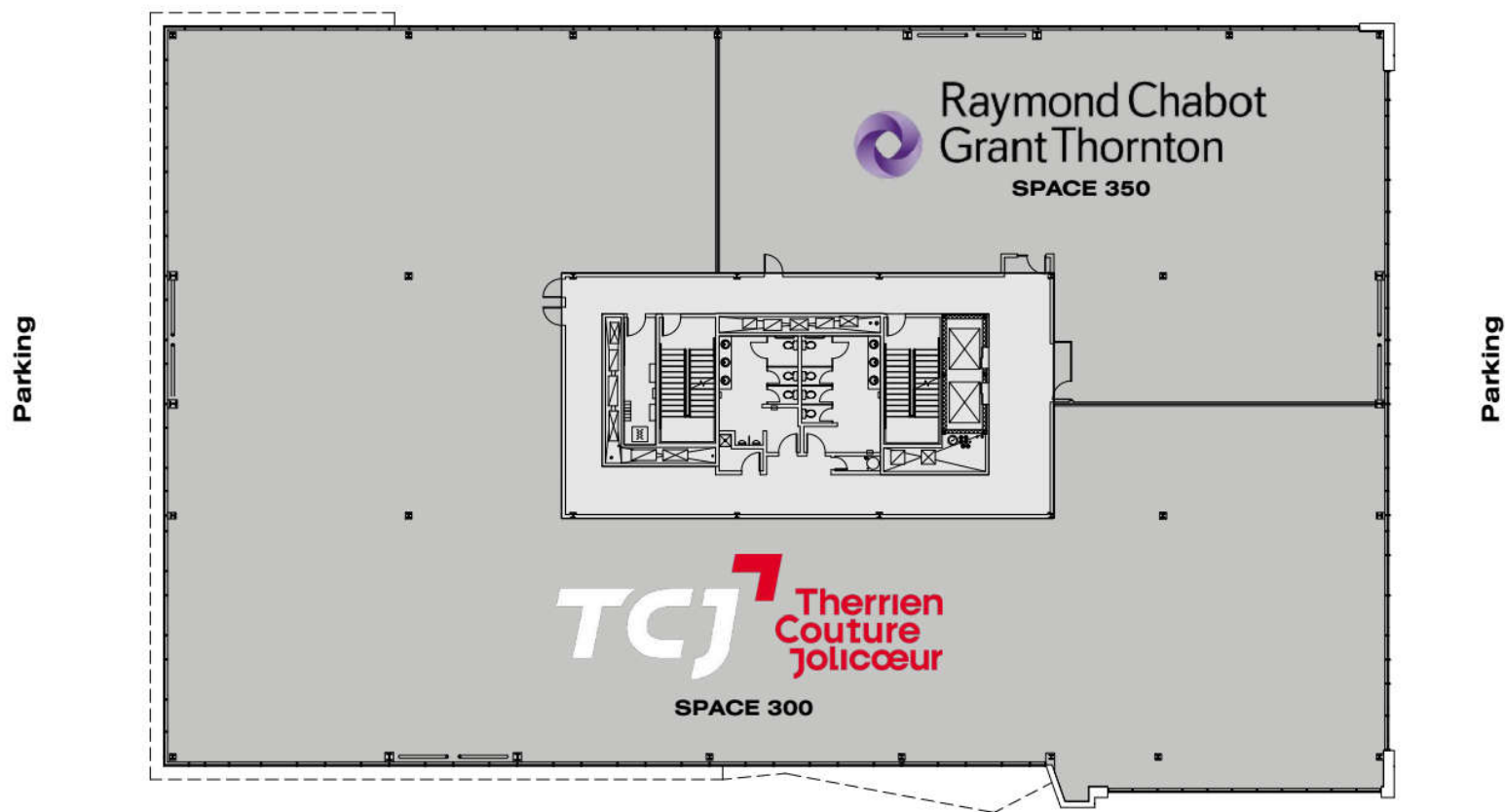

\* Dividing walls can be added as required.

King Street West

LEVEL 3



# PLAN 2207, KING STREET WEST

## LEVEL 4 / PROMENADES KING

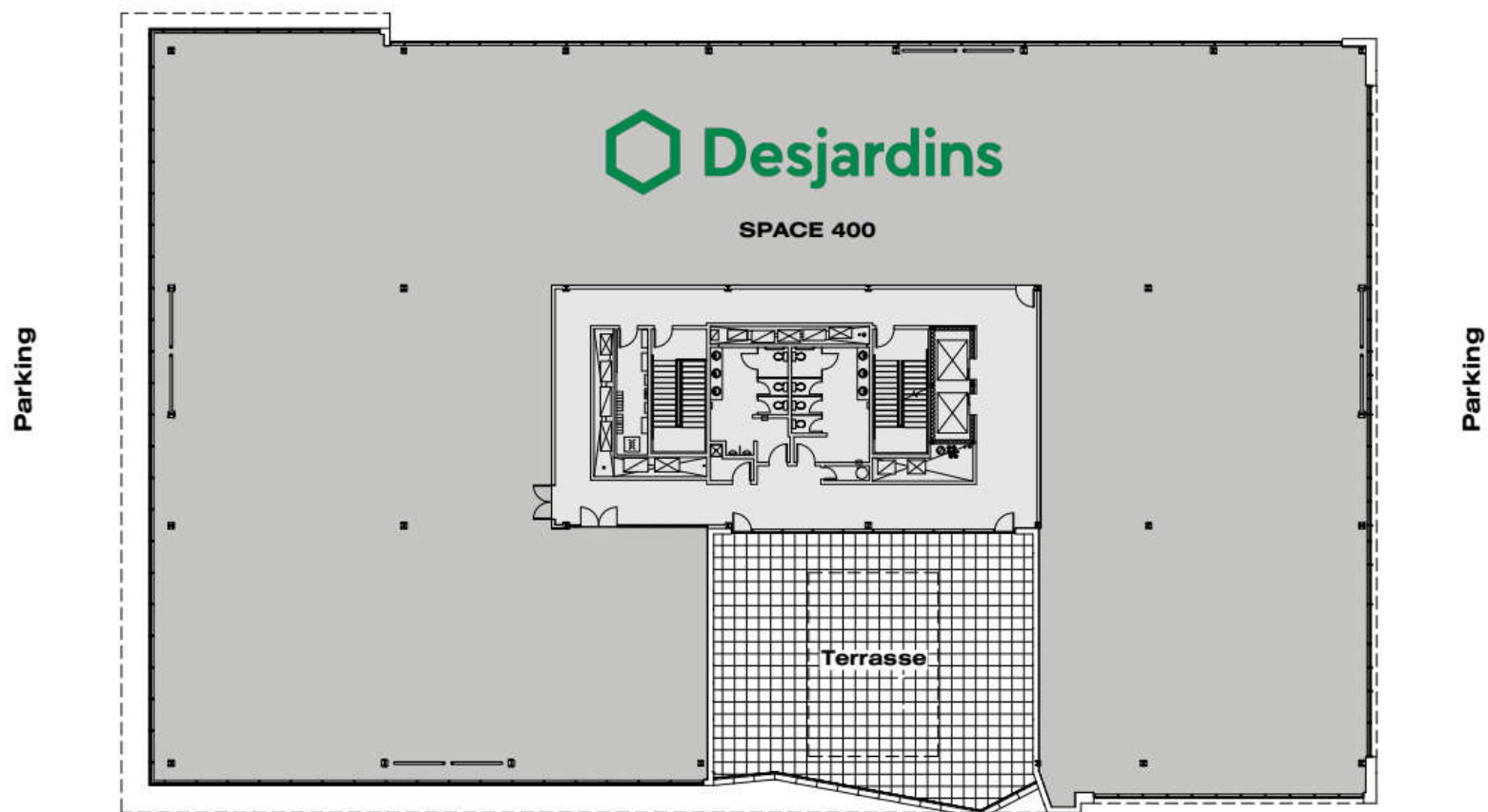

King Street West

LEVEL 4



# **IMMEX SOCIÉTÉ IMMOBILIÈRE**

## **QUALITY, CUSTOMIZED AND PROMPT SERVICES**

**MORE THAN 1.9 MILLION SQ. FT.  
OF OFFICE, COMMERCIAL,  
AND INDUSTRIAL SPACES**

---

**FOUNDED OVER 50 YEARS AGO**

---



**IMMEX SOCIÉTÉ IMMOBILIÈRE PROMOTES  
SOCIAL ENGAGEMENT IN THE COMMUNITY  
AND IS COMMITTED TO REDISTRIBUTING  
1% OF ITS ANNUAL REVENUES TO VARIOUS  
CAUSES AND CHARITIES.**

### **A HIGHLY REGARDED COMPANY**

IMMEX Société Immobilière owns more than 1.9 million square feet of property in approximately 30 office, commercial, and industrial buildings, and more than 3 million square feet of land for development.

Founded over 50 years ago, IMMEX Société Immobilière has acquired extensive expertise and recognition as a leader in real estate development and management in Sherbrooke.

### **IMMEX SOCIÉTÉ IMMOBILIÈRE TEAM**

The IMMEX Société Immobilière team is composed of more than 30 dedicated employees who are experienced in development, property management, and building maintenance. Our qualified team is made up of project managers, builders, and entrepreneurs.

### **QUALITY SERVICES FOR OUR TENANTS**

IMMEX Société Immobilière is known as an efficient real estate developer and property manager. We take great care to maintain and modernize our buildings. Our commitment to our tenants is characterized by our personal service and our prompt response time.



[IMMEX.CA](http://IMMEX.CA)