

rue King Ouest

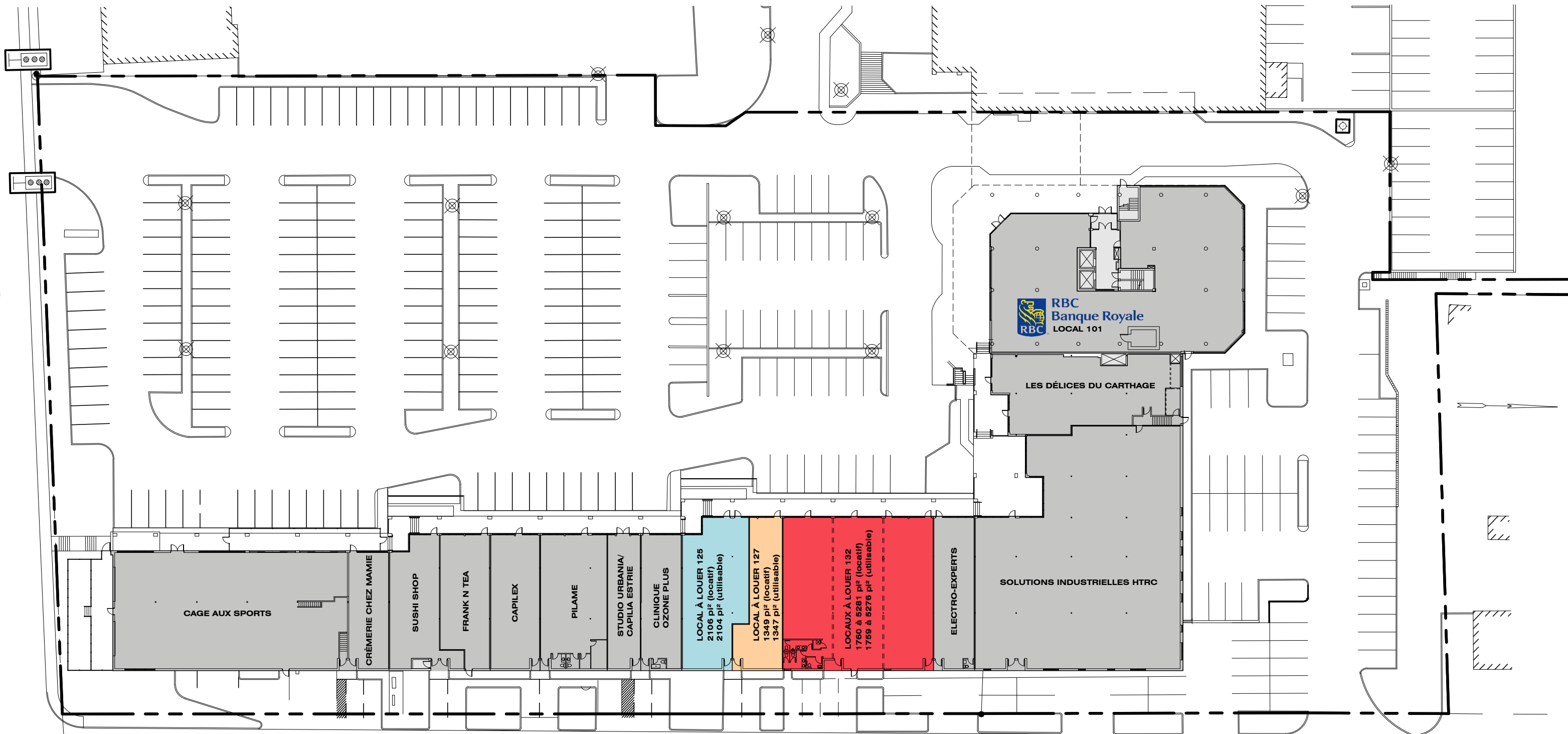

rue Wilson

PLACE DES CONGRÈS - 2655-2665 rue King Ouest

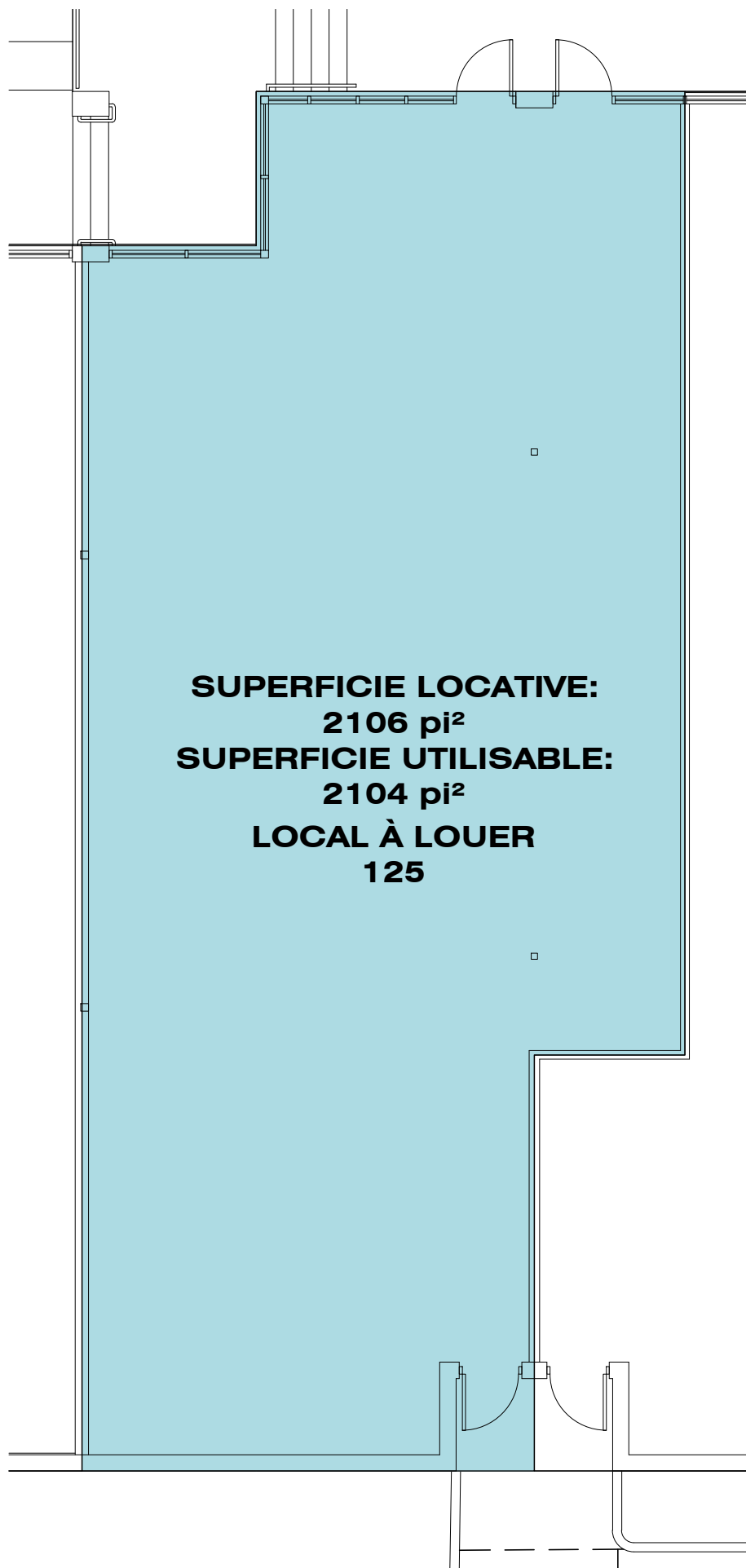

**SUPERFICIE LOCATIVE:
2106 pi²
SUPERFICIE UTILISABLE:
2104 pi²
LOCAL À LOUER
125**

LOCAL 125
ÉCH: 1:100

SUPERFICIE LOCATIVE: →
1349 pi²
SUPERFICIE UTILISABLE:
1347 pi²
LOCAL À LOUER
127

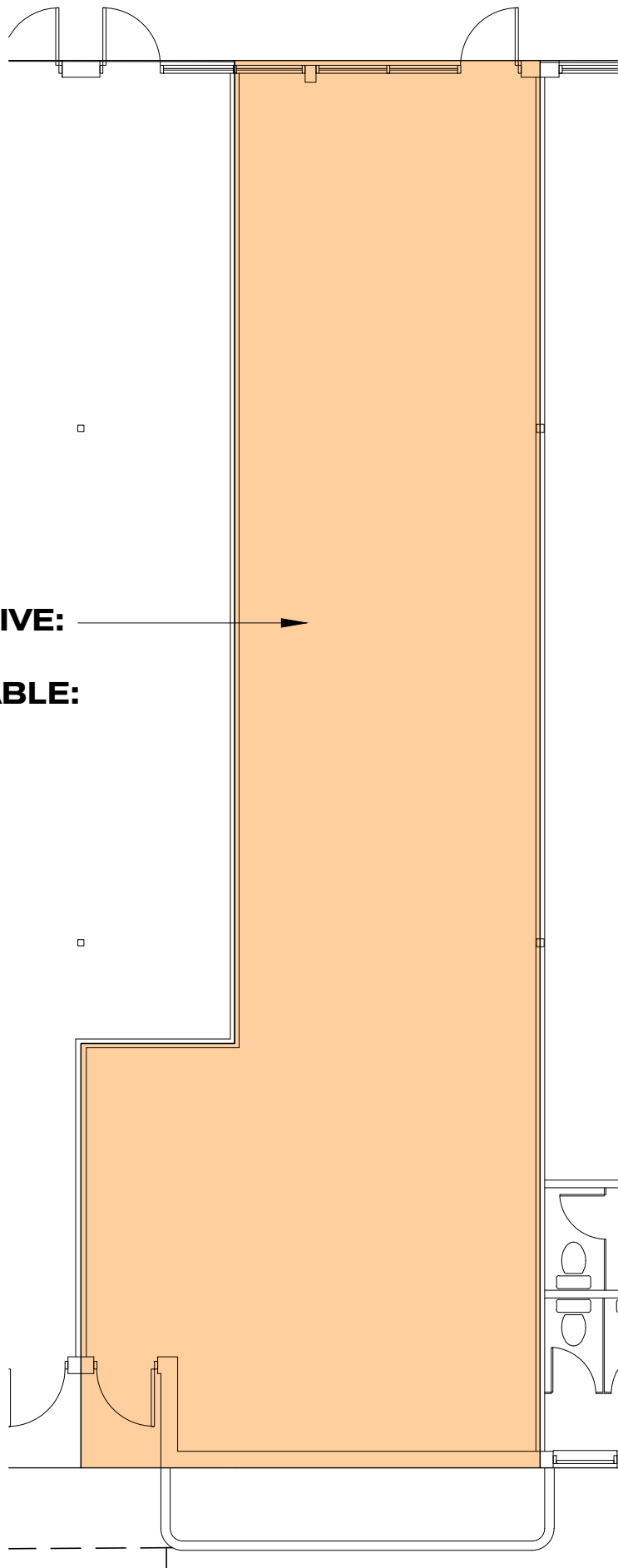

LOCAL 127
ÉCH: 1:100

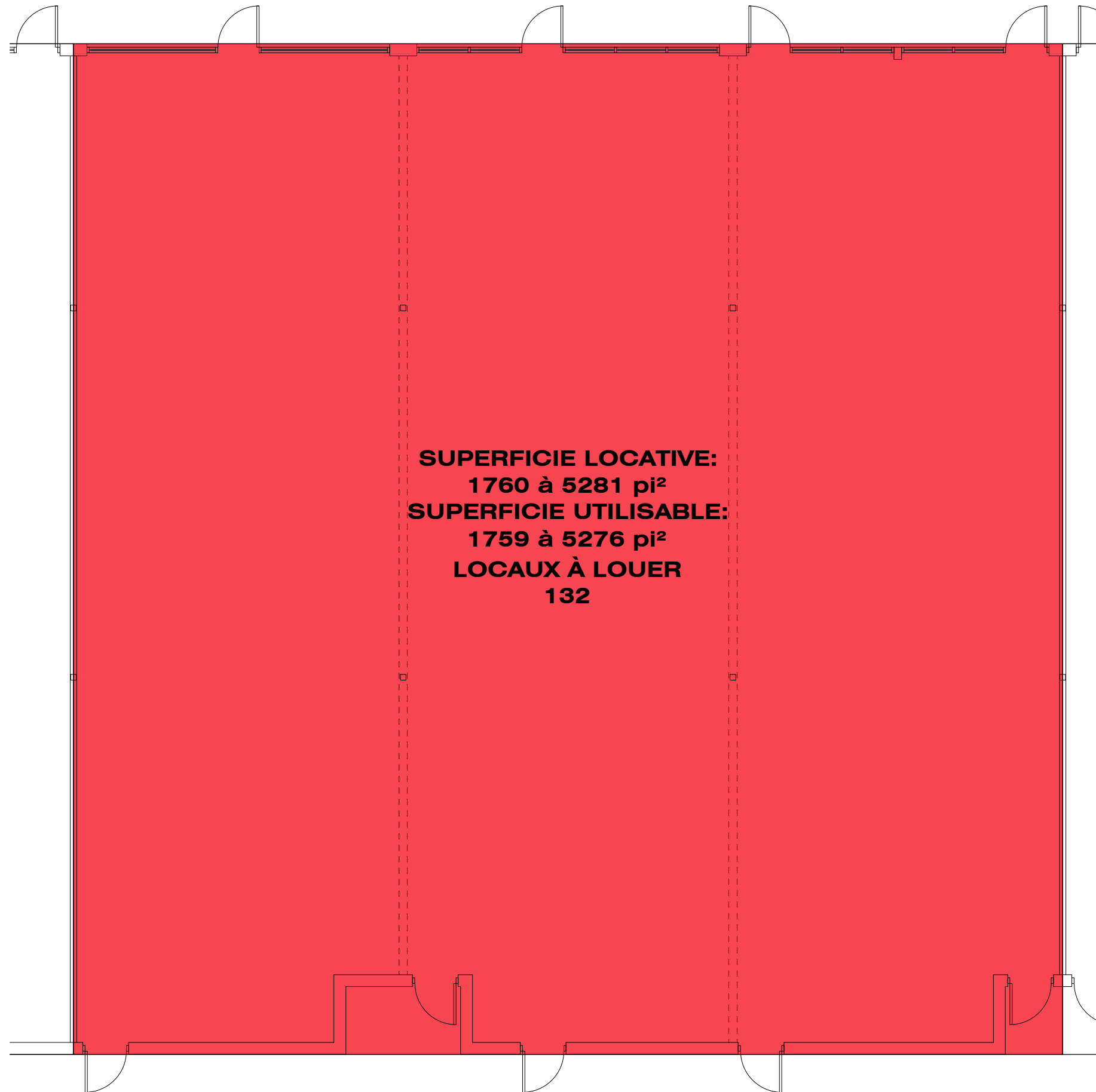

LOCAL 132

ÉCH: 1:100