



**CITÉ DU PARC /  
75-107 JACQUES-CARTIER BOULEVARD SOUTH  
OFFICE AND COMMERCIAL - 1,500 TO 15,000 SQ. FT.**





# INFORMATION

**CITÉ DU PARC / 75-107 JACQUES-CARTIER BOULEVARD SOUTH**

**LOCATED AT THE HEART OF SHERBROOKE'S BUSINESS CENTER AND CLOSE TO SEVERAL RESTAURANTS, GROCERY STORES, PUBS/RESTAURANT BARS, BANKS, PHARMACIES, A MUNICIPAL PARK, BIKE PATH, YOGA STUDIO, MEDICAL CLINIC, GAS STATION AND SEVERAL OTHER BUSINESSES.**

## LOCATION

- Located on the west side of Jacques-Cartier Boulevard South at the corner of Wigget Street.

## LAYOUT

### Interior Height:

- Commercial: 15 feet
- Office: 10 feet

## DETAILS

- The Cité du Parc houses 3 buildings with about 265,000 sq. ft. and a 45,000 sq.ft. Provigo Le Marché supermarket
- Interior parking spaces connected with the 3 buildings for employees and exterior for customers
- Economic use of energy with a geothermic heating and air conditioning system
- Elevators and a rooftop terrace for employees
- Available spaces ready to be developed



# CURRENT TENANTS

75-107 JACQUES-CARTIER BOULEVARD SOUTH



LE FABRICANT DE MATELAS



# CURRENT TENANTS

## CITÉ DU PARC



LE FABRICANT DE MATELAS





# PHOTOS

## 75-107 JACQUES-CARTIER BOULEVARD SOUTH



CITÉ DU PARC – 75-107 JACQUES-CARTIER BOULEVARD SOUTH

CONTACT : SÉBASTIEN MORIN / 819-348-2222  
SMORIN@IMMEX.CA / IMMEX.CA



# PHOTOS

## 75-107 JACQUES-CARTIER BOULEVARD SOUTH





# LOCATION MAP

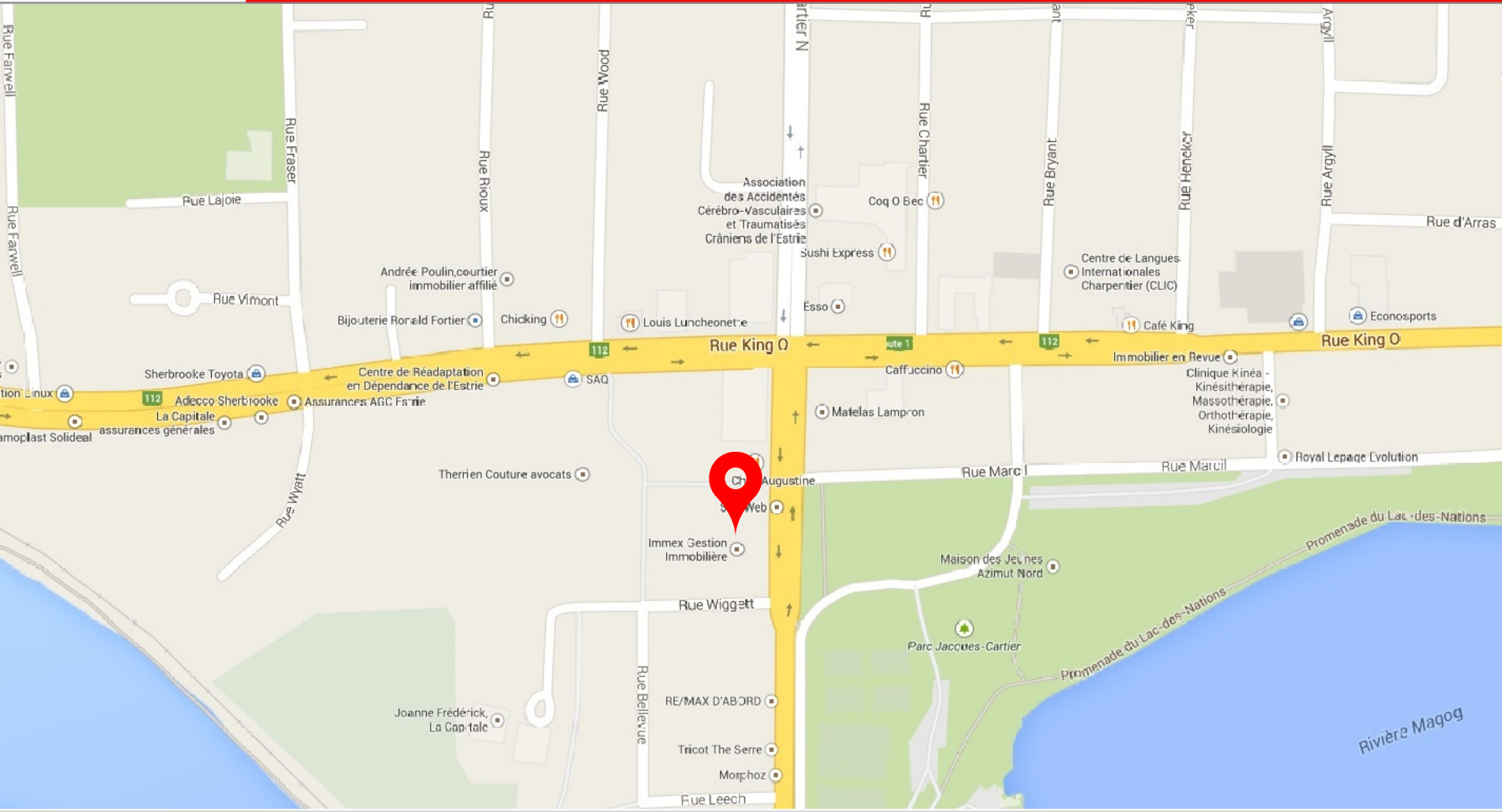

CITÉ DU PARC – 75-107 JACQUES-CARTIER BOULEVARD SOUTH

CONTACT : SÉBASTIEN MORIN / 819-348-2222  
SMORIN@IMMEX.CA / IMMEX.CA



# SITE PLAN CITÉ DU PARC

1900-1920 KING ST. WEST



LEVEL 2



LEVEL 3

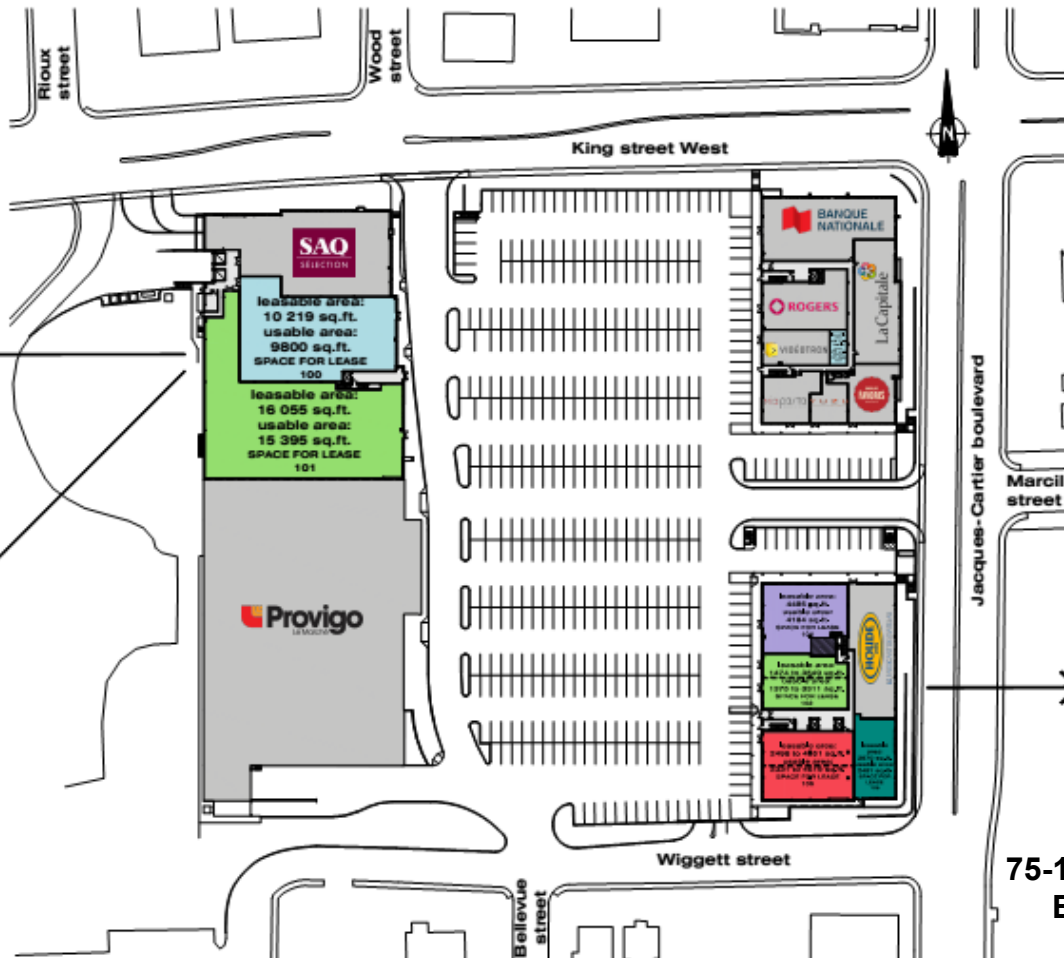

1800-1836 KING ST. WEST



LEVEL 5

75-107 JACQUES-CARTIER BOULEVARD SOUTH





# PLAN

## GROUND FLOOR /

### 75-107 JACQUES-CARTIER BOULEVARD SOUTH

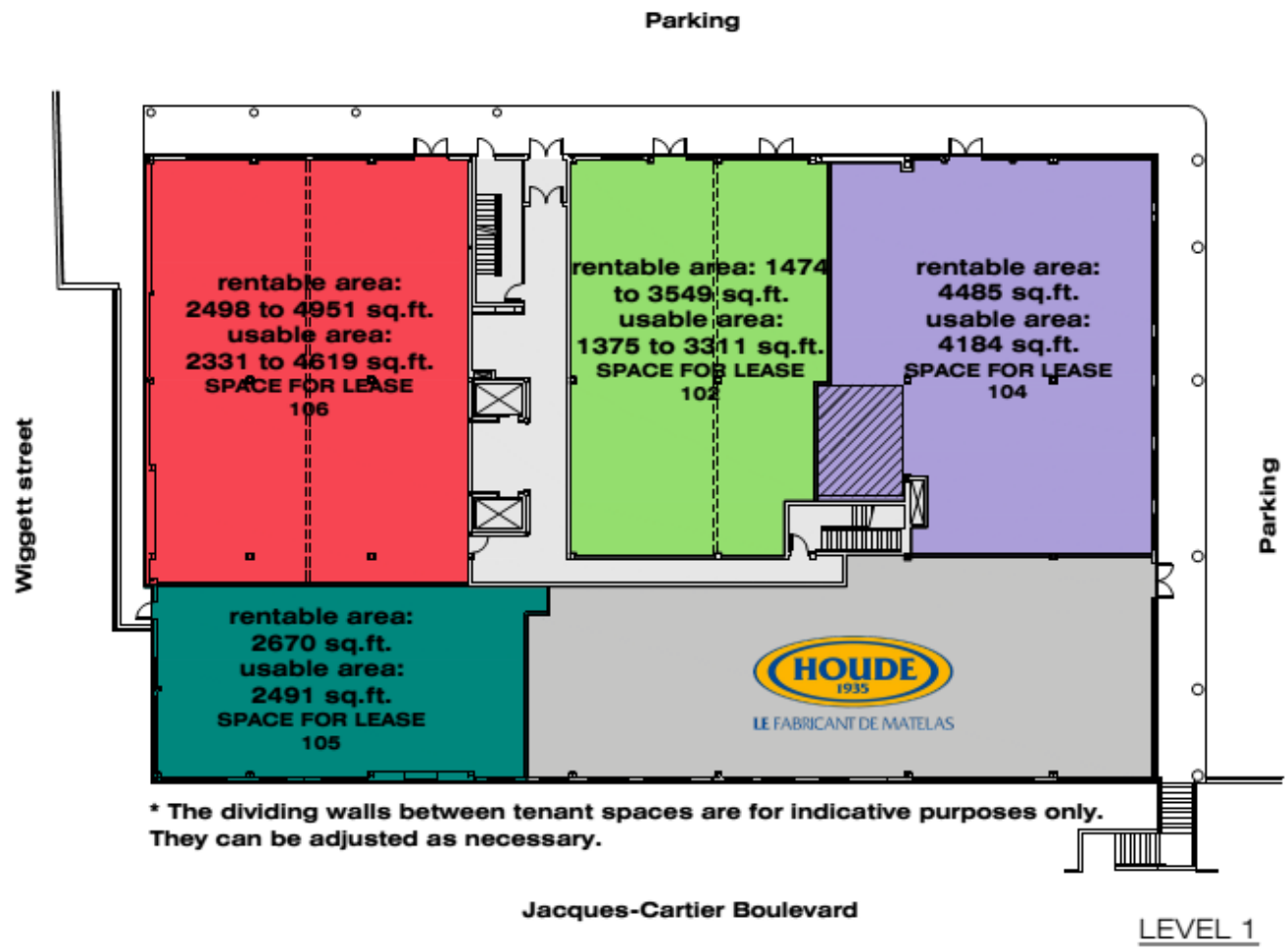



# PLAN

## LEVEL 5 / 75-107 JACQUES-CARTIER BOULEVARD SOUTH

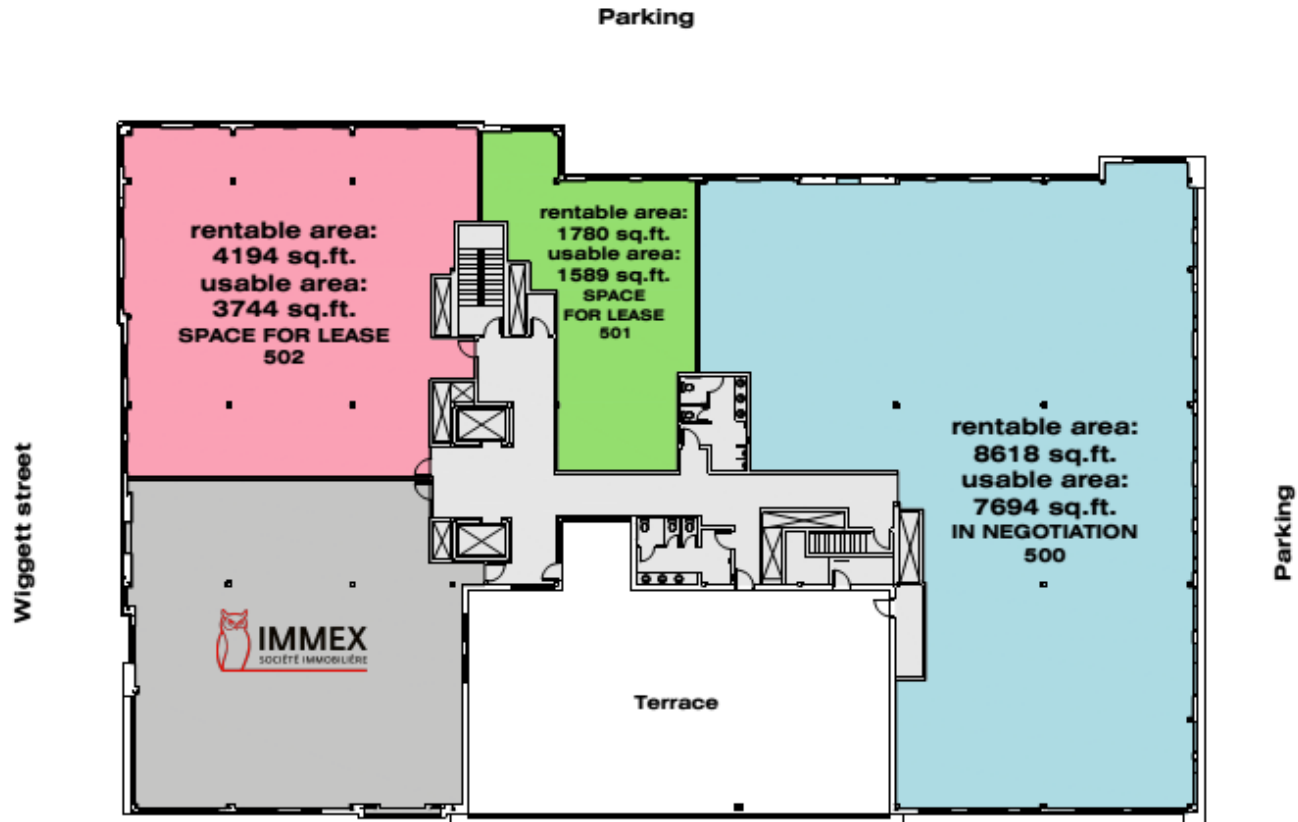

\* The dividing walls between tenant spaces are for indicative purposes only. They can be adjusted as necessary.

Jacques-Cartier Boulevard

LEVEL 5



# IMMEX

## QUALITY, PERSONALIZED AND FAST SERVICES

**MORE THAN 1.4 MILLION SQ. FT.  
OF OFFICE, COMMERCIAL  
AND INDUSTRIAL SPACES**

---

**FOUNDED OVER 40 YEARS AGO**

---



**IMMEX PROMOTES SOCIAL ENGAGEMENT  
IN THE COMMUNITY AND IS COMMITTED  
TO REDISTRIBUTING 1% OF ITS  
ANNUAL REVENUES TO VARIOUS  
CAUSES AND CHARITIES.**

### **A HIGHLY-REGARDED COMPANY**

IMMEX owns more than 1.4 million square feet of property in approximately thirty office, commercial and industrial buildings, more than 650 apartments located in twelve residential buildings and more than over 3.5 million square feet of land for development.

Founded over 40 years ago, IMMEX Société Immobilière has acquired extensive expertise and recognition as a leader in real estate development and management in Sherbrooke.

### **IMMEX TEAM**

The IMMEX team can rely on more than 30 dedicated employees who are experienced in development, property management and building maintenance. Our qualified team is made up of project managers, builders and entrepreneurs.

### **QUALITY SERVICES FOR OUR TENANTS**

IMMEX is known as an efficient real estate developer and property manager. We take great care to maintain and modernize our buildings. Our commitment to our tenants is distinguished by our personal service and our quick response time.



[IMMEX.CA](http://IMMEX.CA)